

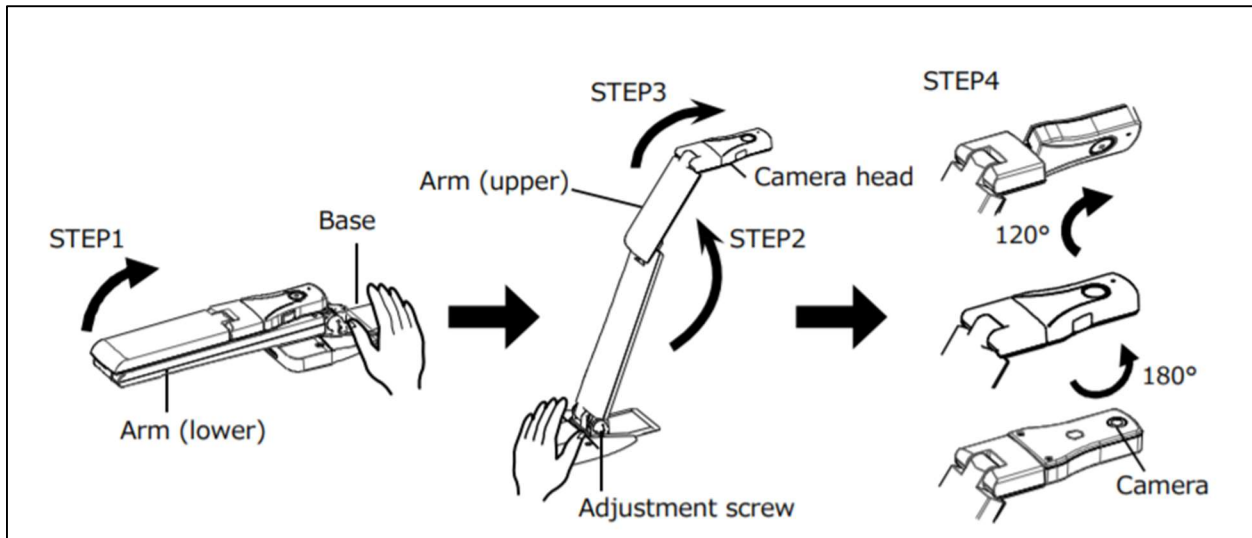

How to Connect & Use the Elmo 0X-1 with a Chromebook

Once you get the Elmo 0X-1 document camera out of the box you can follow the instructions provided by the manufacturer. [Here is a summary:](#)

1. Raise the camera head as indicated by the rightward pointing arrow and while holding down the base.
2. Raise the upper arm in an upward direction as indicated by the upward pointing arrow next to STEP2.
3. Set the camera head horizontally.
4. Rotate the camera angle to your desired angle.
5. Connect the camera to your computer using the provided USB cable.



6. Connect the type B connector of the supplied USB2.0 cable to USB connector in the side of the product.
7. Connect the type A connector of the USB2.0 cable to the USB port of your running computer.
8. Select the **Launcher** , type "Camera" into the search bar (bottom left corner of your screen)
9. Select the **Camera**  icon to open the camera.

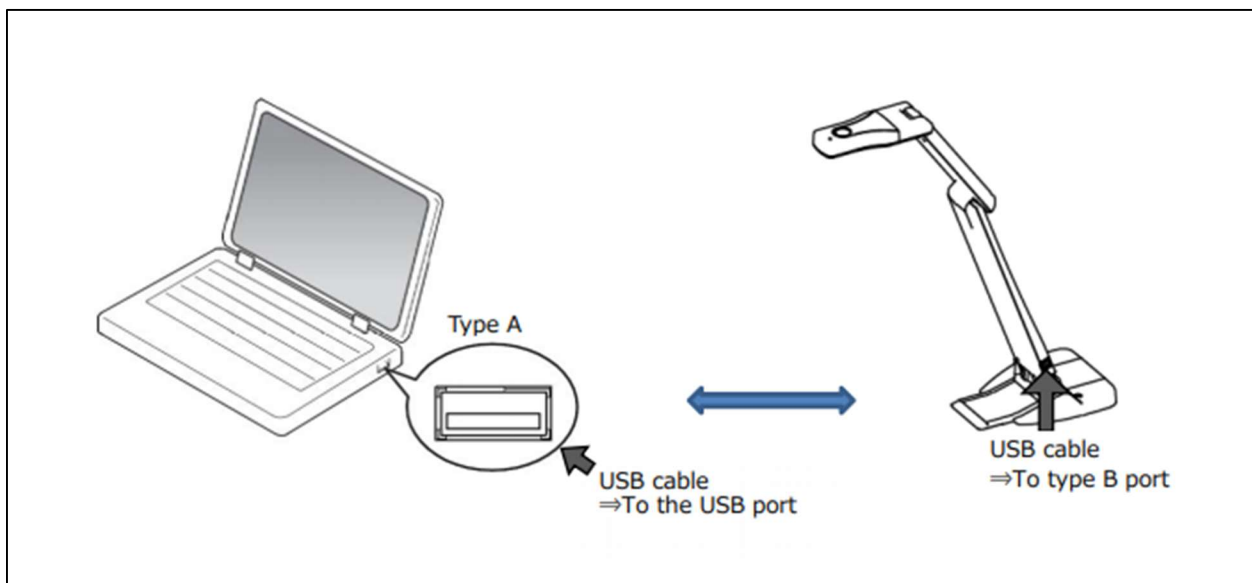

Note: The device will not turn on or be viewable in the camera window unless the external camera has been connected to the laptop before the camera app is launched.